

CEDAR AVE

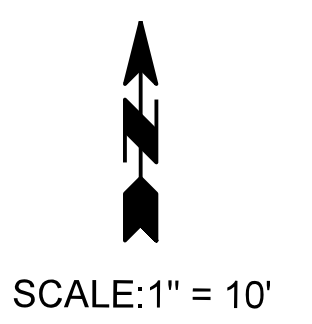

EXISTING LEGEND

- STORM SEWER
- SANITARY SEWER
- COMBINED SEWER
- WATER MAIN
- EXISTING CONTOUR
- EXISTING SPOT ELEVATION
- MANHOLE
- CATCHBASIN
- INLET
- FIRE HYDRANT
- VALVE VAULT
- FLARED END SECTION
- LIGHT POLE
- UTILITY POLE
- CABLE TELEVISION
- ELECTRIC
- GAS
- TELEPHONE
- TREE

PROPOSED SIDEWALK

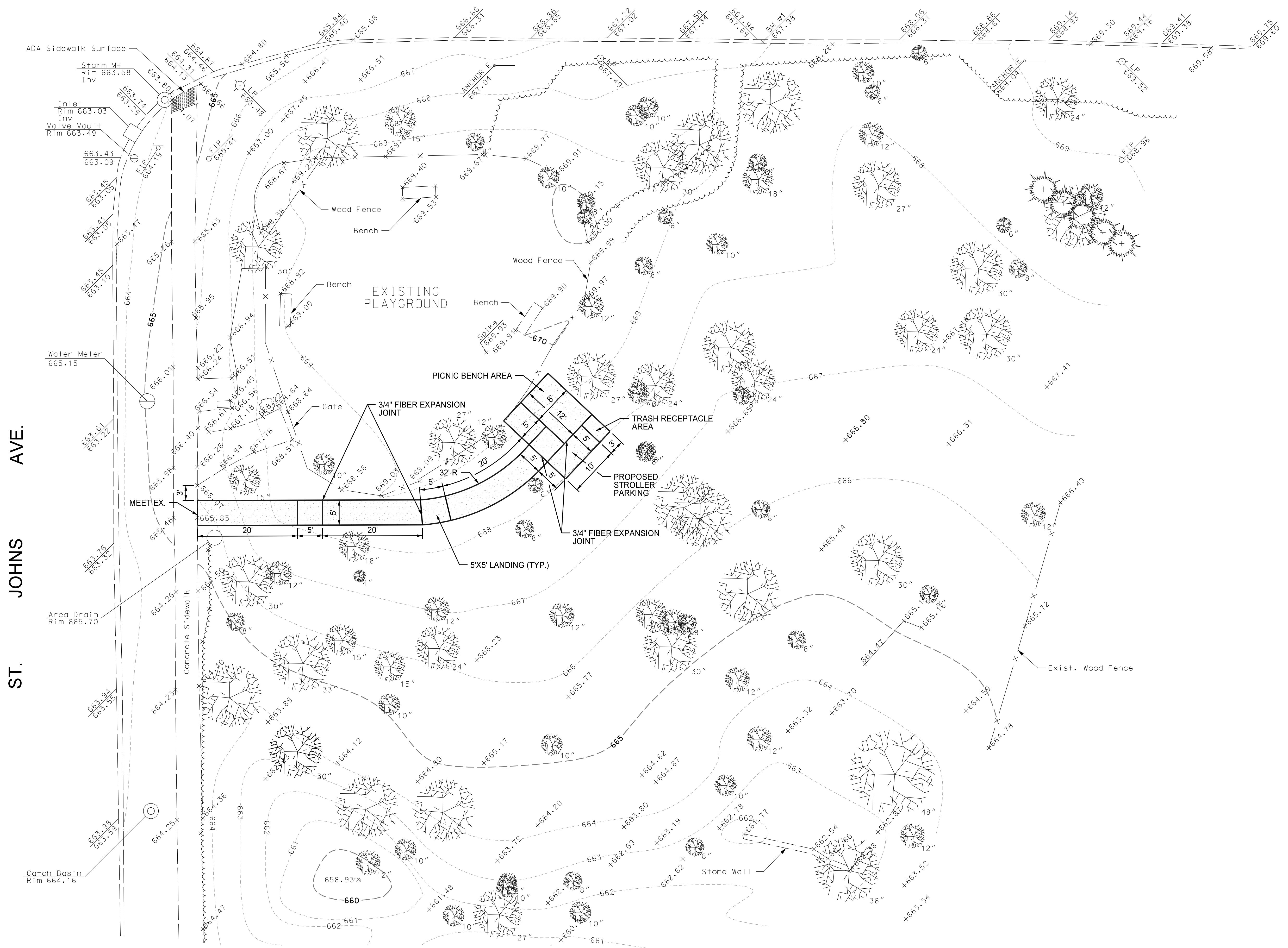

11/14/2022
I:\06\6997-C\CAD\02_Proposed Improvements Plan.dgn
JP\ENTLBS

BENCHMARK:
BM #1 CUT "X" ON SOUTH CURB AND GUTTER OF CEDAR AVENUE 113 FEET EAST FROM SAINT JOHNS AVENUE EAST EDGE OF PAVEMENT.
BENCHMARK DETERMINED USING GPS WITH THE ILLINOIS EAST 1201 COORDINATE SYSTEM, NAVD88

J.U.L.I.E.
JOINT UTILITY LOCATION INFORMATION FOR EXCAVATION CALL 811
Know what's below. Call before you dig.

DANIEL CREANEY COMPANY
CONSULTING CIVIL ENGINEERS
450 SKOKIE BLVD. SUITE 105
NORTHBROOK, ILLINOIS (847) 480-5757

DESIGNED BY: R.H. CHECKED BY: R.H. SCALE: 1" = 10'
DRAWN BY: J.S. JOB NO.: 6997-C BOOK: _____

MORONEY PARK PLAYGROUND
ACCESSIBLE ACCESS
HIGHLAND PARK, ILLINOIS

GEOMETRIC & PAVING PLAN

IN PROGRESS PLAN 11-14-2022			SHEET
			2
			OF 4
DATE	BY	REVISION	DATE 10-12-2022